



CORRY MICRONICS, INC **PROPOSED**  
**PRODUCT SPECIFICATION**

**CMIBPF-47.2-51.4G**  
**Band Pass Filter**

<b>Parameters</b>	<b>Specifications</b>
Frequency Range	47.2 – 51.4 GHz (4.2 GHz BW)
Center Frequency	49.3 GHz
Pass Band Insertion Loss	2 dB Max
Pass Band Ripple (peak to peak over any 500 MHz interval @ 47.2 – 51.4 GHz)	0.3 dB Max
Group Delay Variation (peak to peak over any 500 MHz interval @ 47.2 – 51.4 GHz)	0.3 ns max
Return Loss	15 dB Min
Rejection @ DC to 42.5 GHz	80 dB Min
Rejection @ 42.5 to 46 GHz	40 dB Min
Rejection @ 52.5 to 55 GHz	40 dB Min
Rejection @ 55 to 70 GHz	60 dB Min
Power Rating	10 W Max
Operating Temperature	-30° to +70° C
Impedance	50 Ohms
Input Connector	2.4 mm Female
Output Connector	2.4 mm Male
Finish	Blue Paint
Dimensions	See Attached Drawing

**CALL OUR SALES DEPARTMENT FOR MORE INFORMATION OR VARIATIONS OF THIS PRODUCT.**

**Corry Micronics, Inc. One Plastics Rd. - Corry, PA 16407**  
**(724) 940-7556 ext. 138 Fax (724) 940-7707 [www.cormic.com](http://www.cormic.com)**

Corry Micronics Inc. herein referred to CMI, believes this information to be accurate, but makes no warranties, expressed or implied as to the accuracy of this document. CMI assumes no liability for any injury, loss, damage, direct or consequential arising from the use of our products. User assumes all risk whatsoever in connection with its intended use. CMI also reserves the right to change this document without notice. 03/26/2018

## Concept Drawing:

All Dimensions are in mm [inches] Tolerance  $\pm 0.25$  [0.01]

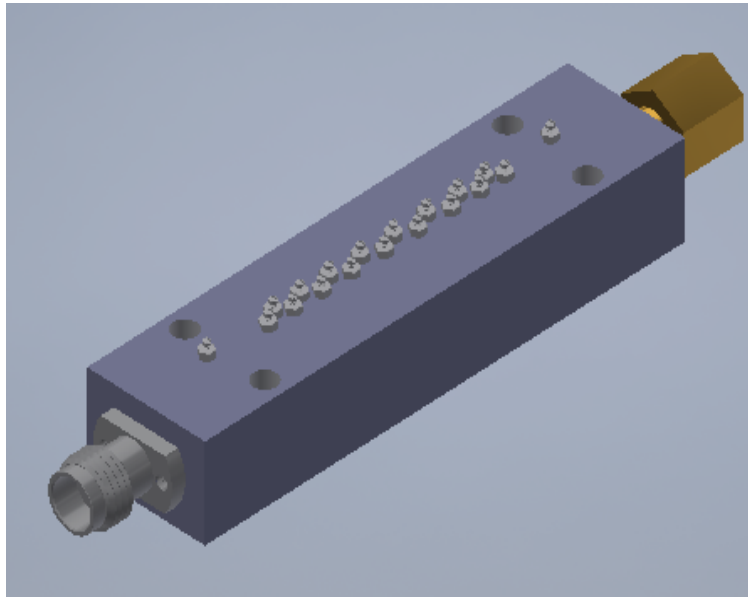
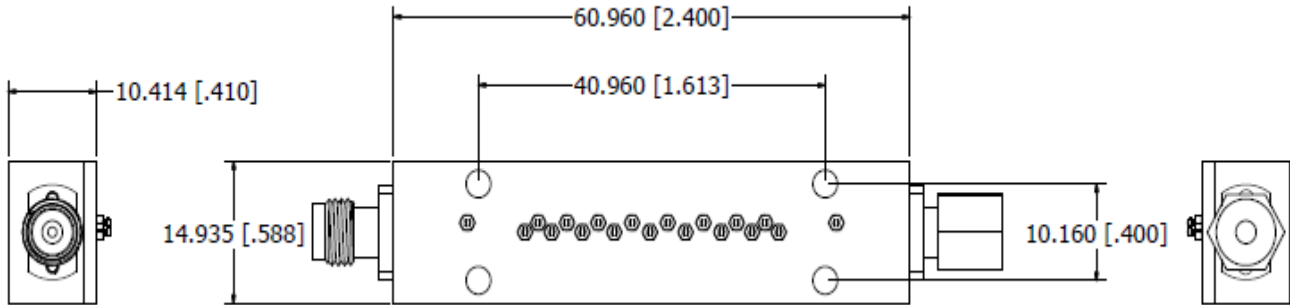

**CALL OUR SALES DEPARTMENT FOR MORE INFORMATION OR VARIATIONS OF THIS PRODUCT.**

**Corry Micronics, Inc. One Plastics Rd. - Corry, PA 16407**  
**(724) 940-7556 ext. 138 Fax (724) 940-7707 [www.cormic.com](http://www.cormic.com)**

Corry Micronics Inc. herein referred to CMI, believes this information to be accurate, but makes no warranties, expressed or implied as to the accuracy of this document. CMI assumes no liability for any injury, loss, damage, direct or consequential arising from the use of our products. User assumes all risk whatsoever in connection with its intended use. CMI also reserves the right to change this document without notice. 03/26/2018